

**PLEASE REVIEW THE INSTRUCTIONS AND WARNINGS LISTED BELOW PRIOR TO PROPER INSTALLATION**

### WARNINGS

- Risk of fire / electrical shock
- LED Fixture installation requires knowledge of luminaire electrical systems.
- Risk of electric shock – disconnect power at source before installation
- Do not make or alter any open holes in an enclosure of wiring or electrical components during installation.
- If lamp or luminaire exhibits abnormal operation (buzzing, flickering, minimal light, etc.), turn off power, remove fixture and contact us. For more information please visit [www.eurilighting.com](http://www.eurilighting.com) or call our toll-free number 1-888-743-5766.
- Wear gloves to prevent cuts/abrasions from sharp edges when removing from carton, handling, and maintaining this fixture.

### CAUTIONS

- Do not use with dimmers.
- Do not look directly at the operating LED Fixture.
- Do not touch this product with wet hands.
- Do not disassemble, repair or alter lamp.
- Designed for indoor applications only.
- Suitable for damp locations.
- The luminaires shall be grounded.
- Be careful not to touch the lamp pins to the metal housing when installing.
- This Device is not intended for use with emergency exits or emergency lights.
- Installation by a licensed Electrician recommended.

### Tools Required

Phillips Screwdriver



Ladder

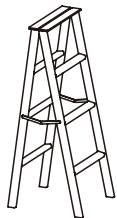

Safety Goggles



### Parts List

Remove the fixture and the mounting package from the box and make sure that no parts are missing by referencing the illustrations on the installation instructions.

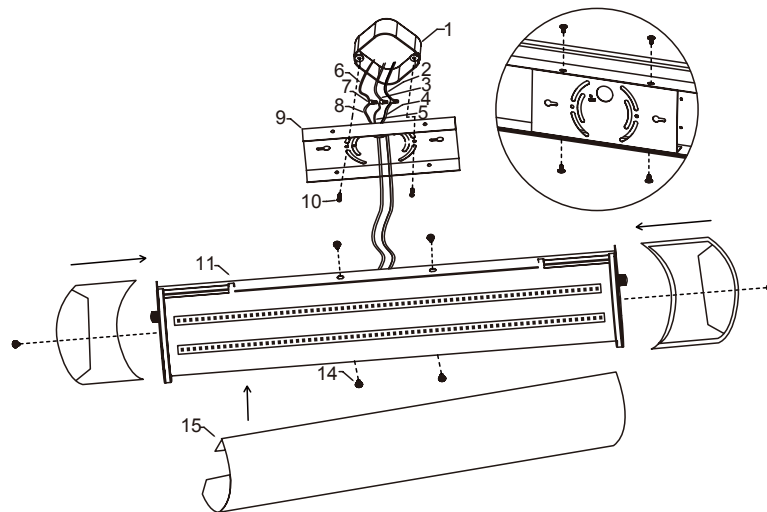

1	Outlet box	9	Mounting Rack
2	Black Supply Wire	10	8-32*15 Machine tapping screw
3	White Supply Wire	11	Base Plate
4	Black Fixture Wire	12	Metal End Caps
5	White Fixture Wire	13	Thumb Screws
6	House Ground Wire	14	Cap Nut
7	P3 Rotatable Connector	15	Acrylic Cover
8	Fixture Ground Wire		

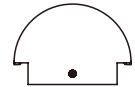

**PLEASE REVIEW THE INSTRUCTIONS AND WARNINGS  
LISTED BELOW PRIOR TO PROPER INSTALLATION**

WARNINGS	CAUTIONS
<ul style="list-style-type: none"> <li>• Risk of fire / electrical shock</li> <li>• LED Fixture installation requires knowledge of luminaire electrical systems.</li> <li>• Risk of electric shock – disconnect power at source before installation</li> <li>• Do not make or alter any open holes in an enclosure of wiring or electrical components during installation.</li> <li>• If lamp or luminaire exhibits abnormal operation (buzzing, flickering, minimal light, etc.), turn off power, remove fixture and contact us. For more information please visit <a href="http://www.eurilighting.com">www.eurilighting.com</a> or call our toll-free number 1-888-743-5766.</li> <li>• Wear gloves to prevent cuts/abrasions from sharp edges when removing from carton, handling, and maintaining this fixture.</li> </ul>	<ul style="list-style-type: none"> <li>• Do not use with dimmers.</li> <li>• Do not look directly at the operating LED Fixture.</li> <li>• Do not touch this product with wet hands.</li> <li>• Do not disassemble, repair or alter lamp.</li> <li>• Designed for indoor applications only.</li> <li>• Suitable for damp locations.</li> <li>• The luminaires shall be grounded.</li> <li>• Be careful not to touch the lamp pins to the metal housing when installing.</li> <li>• This Device is not intended for use with emergency exits or emergency lights.</li> <li>• Installation by a licensed Electrician recommended.</li> </ul>
Installation:	
<ol style="list-style-type: none"> <li>1. Separate the metal end caps (#12) and acrylic cover (#15) from the plate (#11) by loosening the screws (#13) on the end caps with hands.</li> <li>2. Pull the power supply wires out from the outlet box (#1), and thread the wires through the hole in the mounting bracket (#9).</li> <li>3. Install the mounting bracket (#9) on the outlet box (#1), by using machine tapping screws (#10).</li> <li>4. Make the wiring connections by using p3 rotatable connectors (#7): <ul style="list-style-type: none"> <li>Connect white fixture wire (#5) to white supply wire (#3)</li> <li>Connect black fixture wire (#4) to black supply wire (#2)</li> <li>Connect fixture ground wire (#8) to the house ground wire (#6) from the outlet box (#1).</li> </ul> <p><b>*If house wiring includes no ground wire, consult an electrician.*</b></p> </li> <li>5. Mount the fixture base plate (#11) all the way through the screws on the mounting bracket (#9), and tighten the plate on the bracket by cap nut (#14)</li> <li>6. Mount one metal end cap (#12) on one side of the plate (#11), and tighten it by screws (#13) with hands. Slide the acrylic cover (#15) into the mounted metal end cap (#12), then install the other metal end cap on the other side of the plate (#11). Lock it by thumb screw (#13) on the plate (#11)</li> </ol>	