

Shift Chain - Normal type

>> Part of Shift Chain Normal type

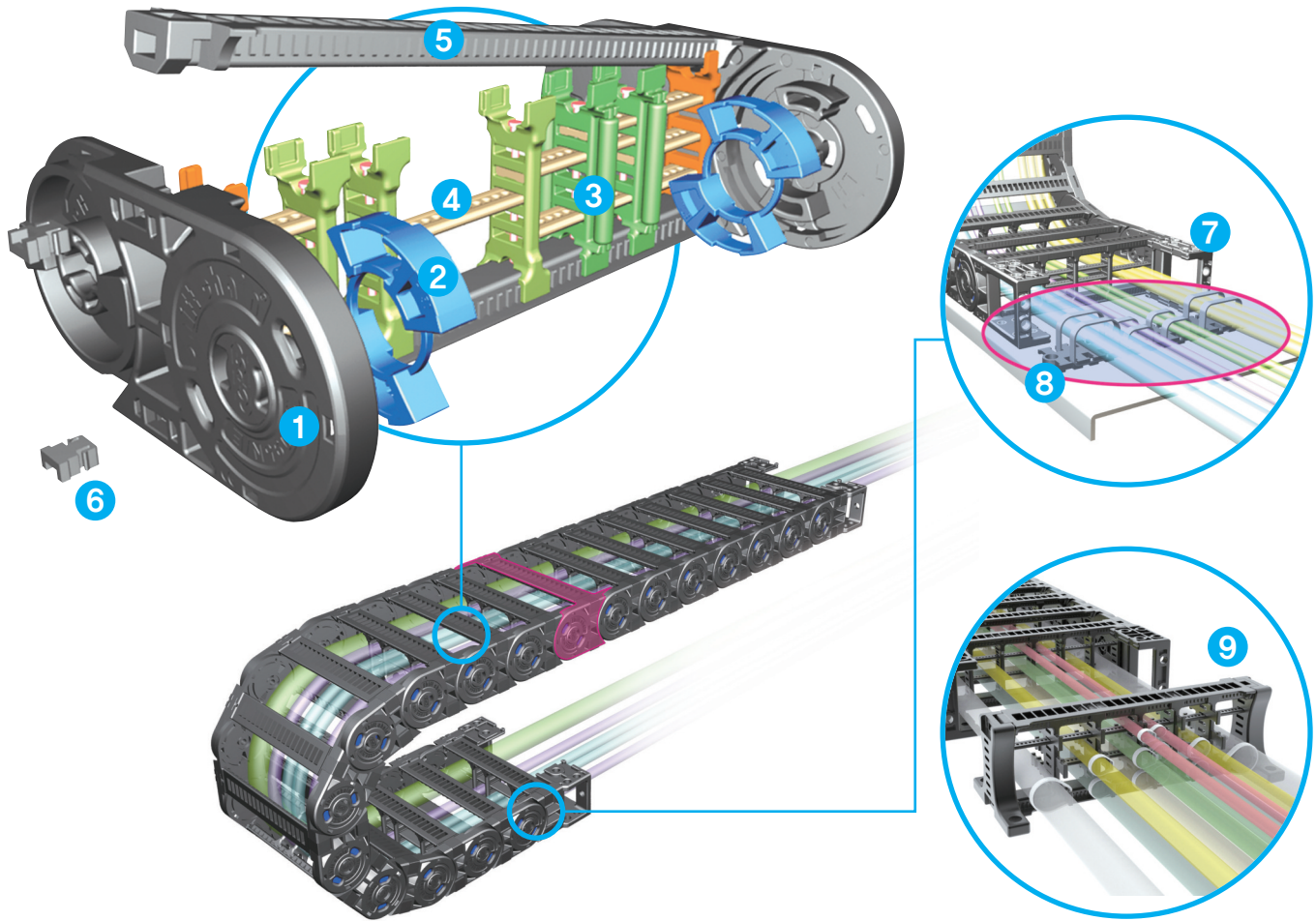

1 Side Band (SB)

A unit that connects each side band and between them BR is inserted to strengthen clamping force.

2 Bending Radius Unit (BR)

A unit that inserted between each side band. There are 6 supporting points to create durability.

3 Divider (DV-S, M, R, T)

A unit that divides inserted cables horizontally.

4 Separator (SP)

A unit that divides inserted cables vertically to prevent twisting and breaking problem.

5 Frame (Hinged Type) (FR)

Hinged-type frame, open one side, supports connection of both side of side band and have tongue and groove system plate to secure the position of the divider on the frame.

6 Frame Pin (FP)

The connecting pin for preventing the breakaway of Frame connected at Side Band, combining and fixing the Frame and Side Band. For Shift chain(ST)072N, 092N, 120N, 150N type, one side of the frame is fixed by inserting a fixing pin to prevent frame open, which caused by any external impact. Also, in case of ST044N, ST055N type, an open side of the frame is fixed by Hook-type frame.

7 Free End Bracket (FEB)

A unit that connects at last side band (left&right). It can be fixed stronger using steel washers.

8 Tie Wrap (TW)

A unit that ties cables to maintain straightness of them. It can be assembled to bracket directly or installed separately from bracket.

9 System Tie Wrap (STW)

System-Tie Wrap has to be assembled on fixing and moving point of bracket and can be assembled without any tie wrap plate. This tie wrap is used to stay the cables on several floors prevent the cables from being twisted and it can also be assemble without any tools or bolt. This tie wrap has two types, one is to assemble inside bracket the other one is outside.

» Assembly procedure of Shift Chain Normal type

The assembling process of Shift Chain N-Type is like below and users must use rubber hammer with careful combination of Divider and Separator. Be careful of different assembling process depending on product specification such as ST044N, 055N Type, ST072N, 095N, 120N Type, ST150N Type etc.

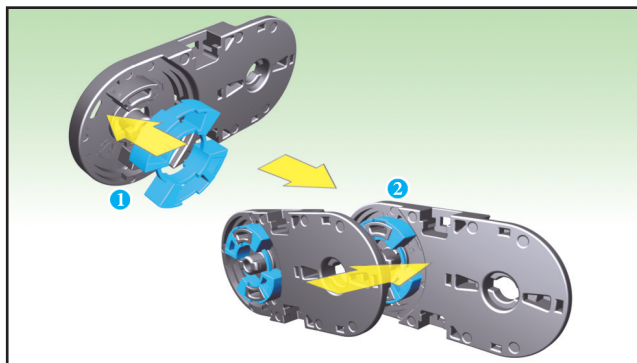

1 Insert BR unit to each side band, connect the side bands as many as you need, then do the same process to the other side of side band.

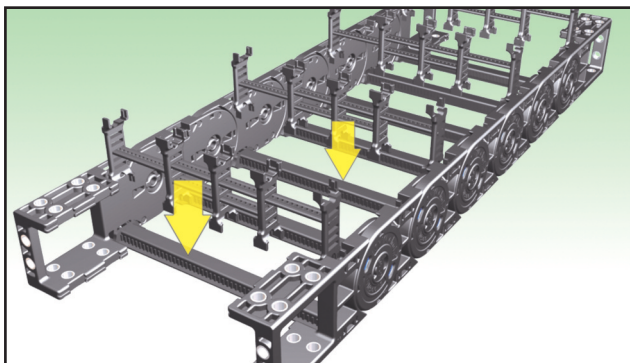

5 Fix the separator and divider patterns to the bottom-side frames as needed.

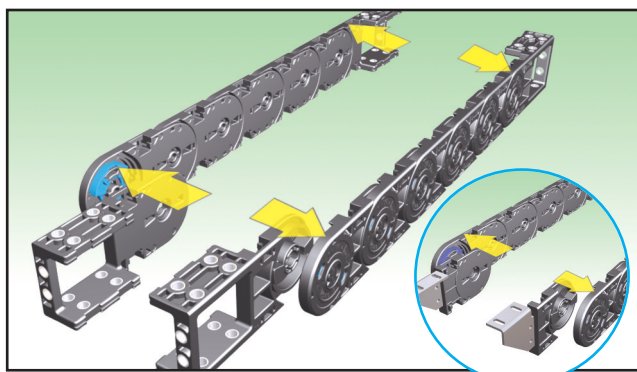

2 Assemble the end brackets on both ends using the same method. For ST150N, assemble steel brackets on both ends.

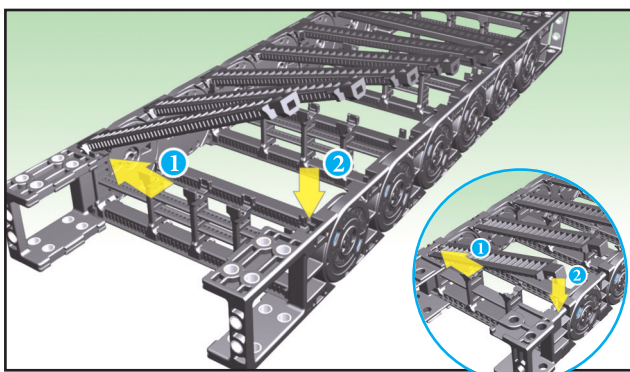

6 Attach frames to one side groove on the side band, and then the other side. ST044N, 055N frame type.

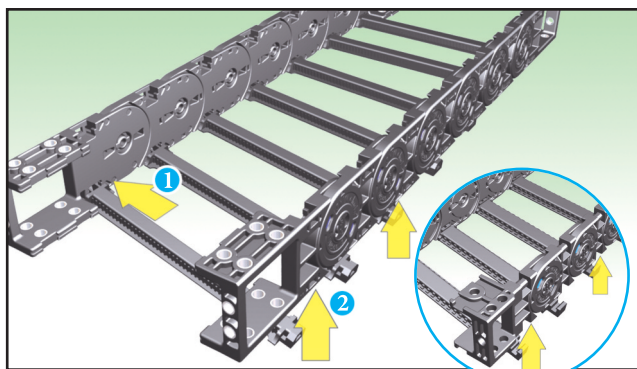

3 Attach frames to one side groove on the side band, and then the other side. ST 044N, 055N are Hinge Type or Hook Type without frame pin.

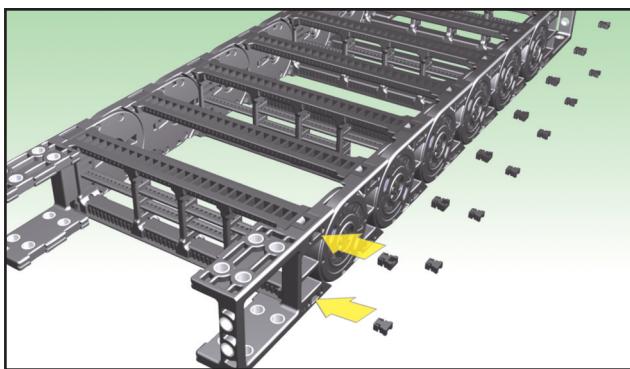

7 Insert frame pins to secure the frames and complete carrier. (ST072N, 095N, 120N, 150N are applied with frame pin, and ST044N, 055N are Hinge Type or Hook Type without frame pin.)

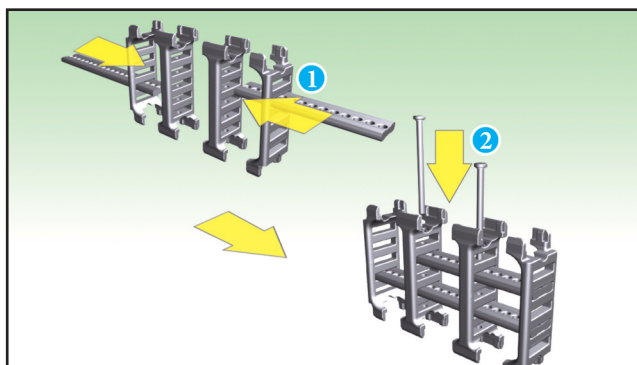

4 For ST072N, 095N, 120N, and 150N, connect the pin of separator in hole of divider after inserting separator in hole of divider. For ST044N and ST055N, separator fixing pins are not used.

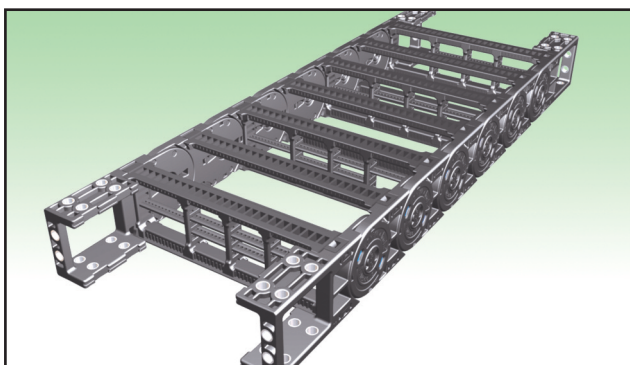

8 Assembled Shift Chain N-Type is assembled.