



**READ ALL WARNINGS AND INSTRUCTIONS PRIOR TO INSTALLING  
THE KOBI LED VAPOR TIGHT TO ENSURE SAFETY AND PROPER OPERATION**

**DO NOT** make or alter any open holes in an enclosure of wiring or electrical components during fixture installation.

**DO NOT** install damaged product. This luminaire has been properly packed so that no parts should have been damaged during transit. Inspect before installation.

**DO NOT** exceed maximum wattage marked on luminaire.

**WARNING** - Risk of fire or electric shock. LED Vapor Tight installation requires knowledge of luminaires electrical systems. If not qualified, do not attempt installation. Contact a qualified electrician.

**WARNING** - To prevent wiring damage or abrasion, do not expose wiring to edges of sheet metal or other sharp objects.

**WARNING** - Verify that supply voltage is correct by comparing it with the luminaire label information.

**WARNING** - Make all electrical and grounded connections in accordance with the NEC and any applicable local code requirements.

#### **Suitable for Wet Locations**

##### **This includes:**

- 1 Kobi Electric LED Vapor Tight
- 1 Safety and Warning Label Sheet
- 1 Installation Instruction Sheet





**SEE REVERSE SIDE - READ ALL WARNINGS AND INSTRUCTIONS PRIOR TO INSTALLING THE KOBI LED VAPOR TIGHT TO ENSURE SAFETY AND PROPER OPERATION**

### INSTALLATION INSTRUCTIONS:



**DANGER - RISK OF SHOCK**  
DISCONNECT POWER BEFORE INSTALLATION

1. Disconnect power supply and remove existing fixture (if applicable)
2. Carefully remove the PC lens by opening the metal clips, then remove aluminum plate by rotating the plastic knob. (Figure A)
3. Screw the two metal brackets to the ceiling, install the housing to the metal brackets. (Figure B)
4. Install the end cap, connect wiring to terminal block through the cable entry hole. (Figure C)
5. Re-install the aluminum plate and PC lens to the housing. (Figure D)
6. Fasten the metal clips. (Figure E)

(Figure A)

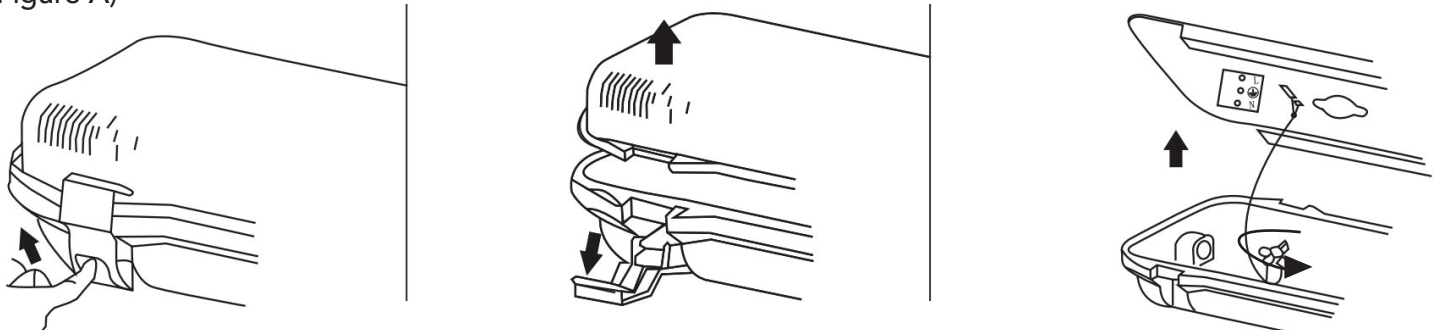

(Figure B)

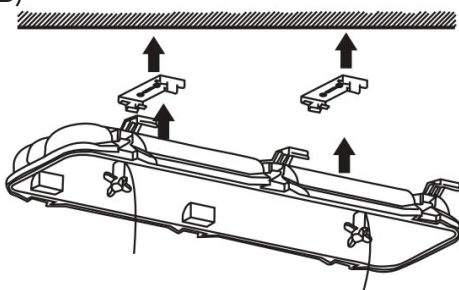

(Figure C)

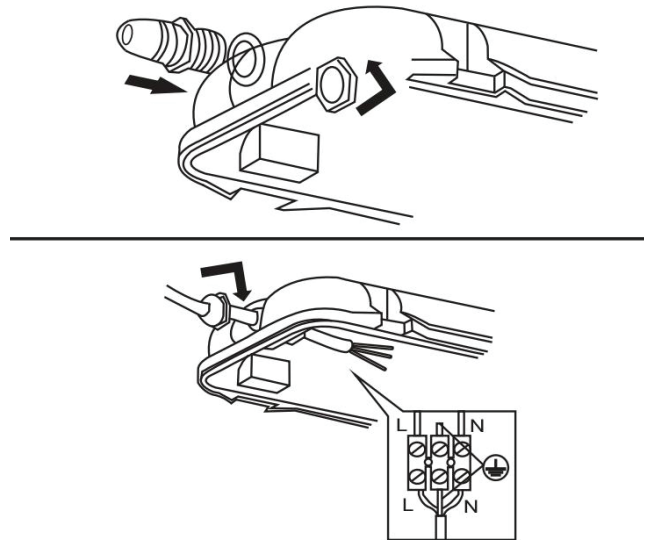

(Figure D)

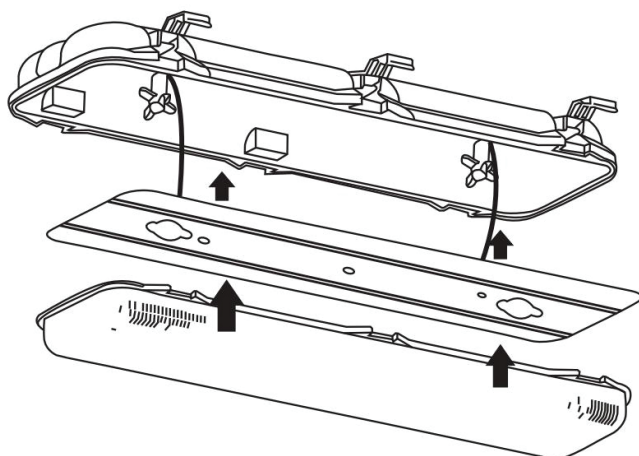

(Figure E)

